

## Site – Renovation

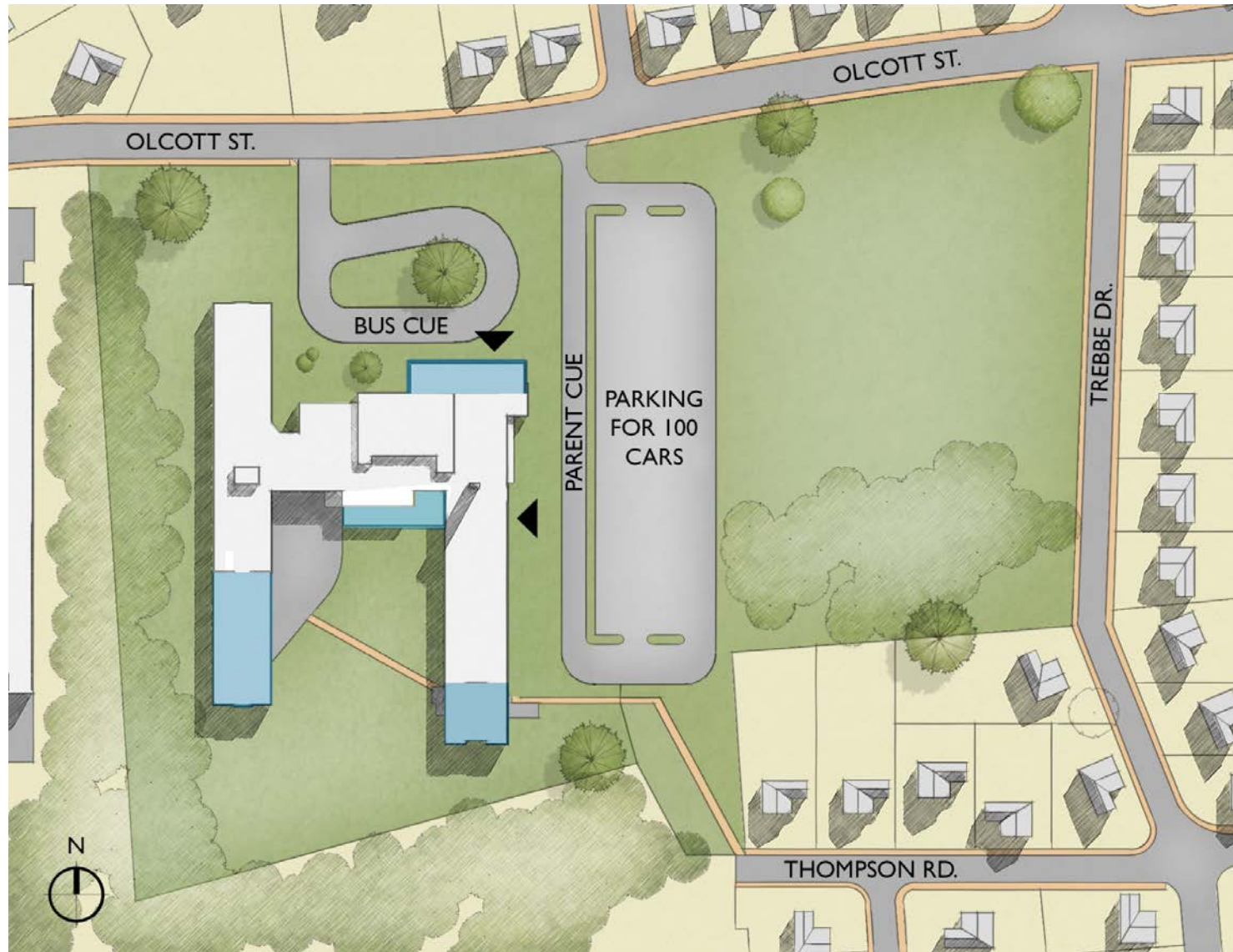

## 3D – Renovation

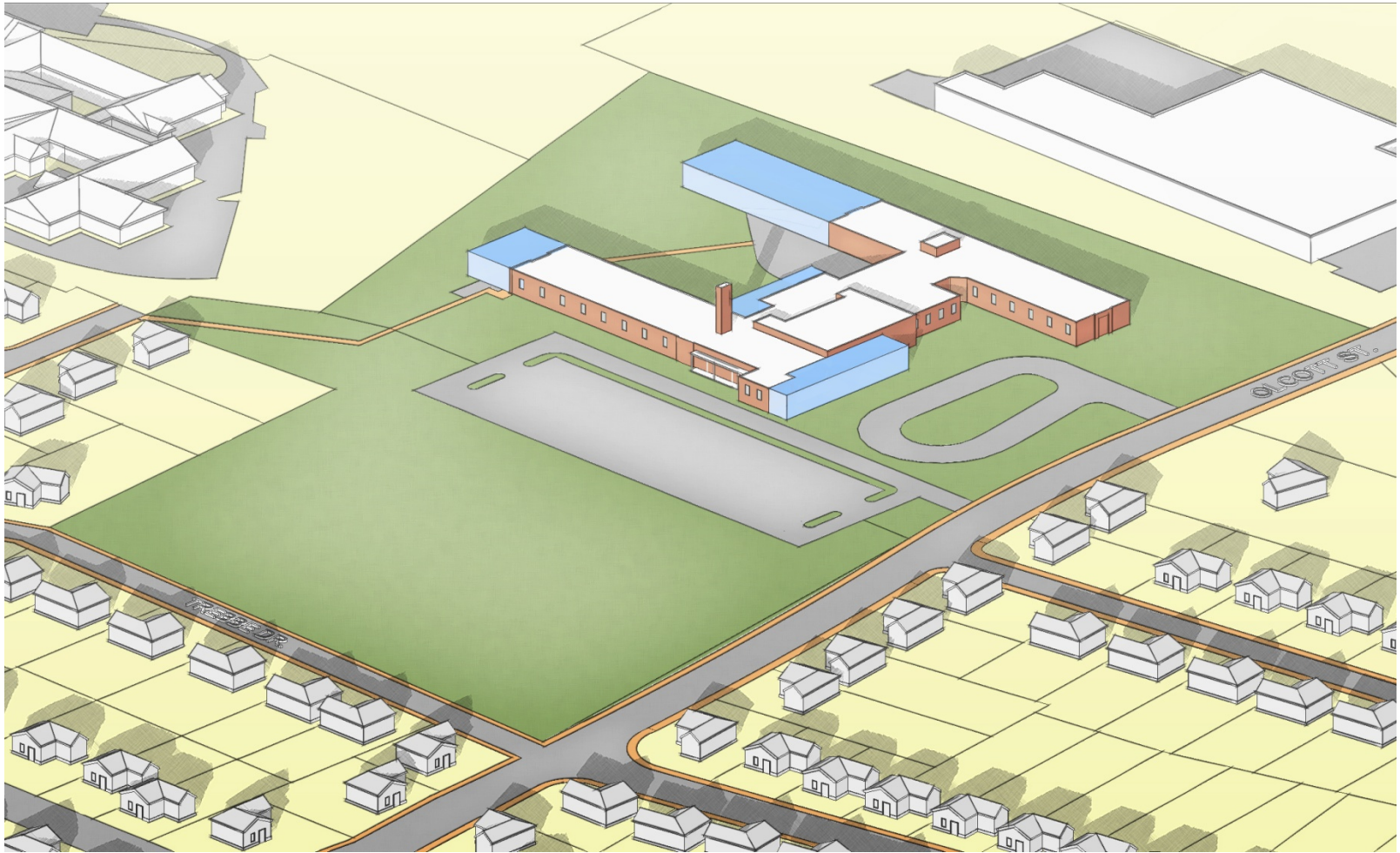

Level I – Renovation





## Program – Renovation

Classrooms		
Enrollment Projection	525 Students	
# of Classrooms Needed	25 Classrooms @ 21 students	
Program	Existing	Renovation
Classrooms	21 @ 860 SF = 18,200 SF	25 @ 940 SF = 23,500 SF
Special Education	4 @ 185 SF = 740 SF	3 @ 210 SF = 630 SF
Small Group	4 @ 225 SF = 900 SF	3 @ 580 SF = 1,740 SF
OT/PT	-	650 SF
Project Classroom	-	850 SF
Art Classroom	-	930 SF
Music Classroom	-	890 SF
Band/Orchestra/Chorus	-	915 SF
Admin/Heath/Nurse	1,600 SF	3,430 SF
Pupil Services	-	1,600 SF
Staff Work	170 SF	330 SF
Staff Lounge	250 SF	240 SF
Cafeteria	2,750 SF	3,600 SF
Library/Media Center	3,300 SF	3,160 SF
Gymnasium	6,250 SF	6,270 SF
NET SF	34,160 SF	48,735 SF
<b>GROSS SF</b>	51,100 SF	<b>70,000 SF</b>

## Conceptual Budget – Renovation

Renovation	\$8,573,000
New Construction	\$6,264,000
HAZMAT Allowance	\$300,000
Sitework Allowance	\$750,000
Sub Total	<b>\$15,887,000</b>
Estimate Contingency	\$3,177,400
Escalation	\$1,715,796
Bond Costs	\$207,802
CM Fee	\$629,640
CM Reimbursables	\$1,246,812
Total Construction Cost	<b>\$22,864,450</b>
Soft Costs	<b>\$5,716,112</b>
Total Project Costs	<b>\$28,580,562</b>
Estimated Eligible Costs	\$27,151,534
Estimated NetState Reimbursement Percentage	67%
Estimated Net Cost to Manchester	<b>\$10,389,034</b>