

Connecticut's New Voting System

This year, all Connecticut voters will use the new electronic voting system in both the general election Nov. 6 and, in some towns, the Sept. 11 primary. The new technology replaces the mechanical lever-style machines that had been in use for decades. Vision- and mobility-impaired voters also will have access to a vote-by-phone system that will enable them to cast their votes privately, as required by federal law. This guide will help familiarize you with both systems

1 CHECK IN

Show driver's license or other proof of identity.



2 TAKE BALLOT

You will receive a placemat-size paper ballot with the candidates listed in rows by party. Take the ballot to one of the "privacy booths" to fill out.

Privacy booth

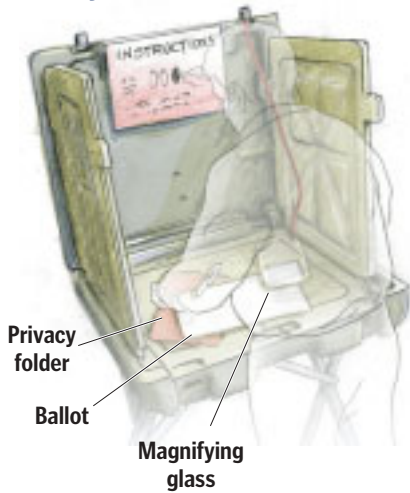

Once the polls close, the results are spit out on a cash-register-like receipt for poll workers.

Storage for unreadable ballots for cases in which voters decline to fill out a substitute ballot.

3 FILL OUT BALLOT

Fill in the ovals next to the names of the candidates you wish to vote for using the pen provided, as you would a lottery ticket or standardized test. A magnifying glass is attached to the booth if you have trouble seeing the print. If you make a mistake and fill in the wrong oval, exchange your ballot for a new one. Ballots also provide space for filling in the names of write-in candidates.

Correct Way



Wrong Way



4 SUBMIT BALLOT

Place your finished ballot in a privacy folder that is provided. Walk your ballot over to a vote-tallying machine and feed it into the slot. The machine will accept the ballot like a vending machine taking a dollar bill.

The ballots fall into two stacks inside the machine. Poll workers count the write-in votes by hand.

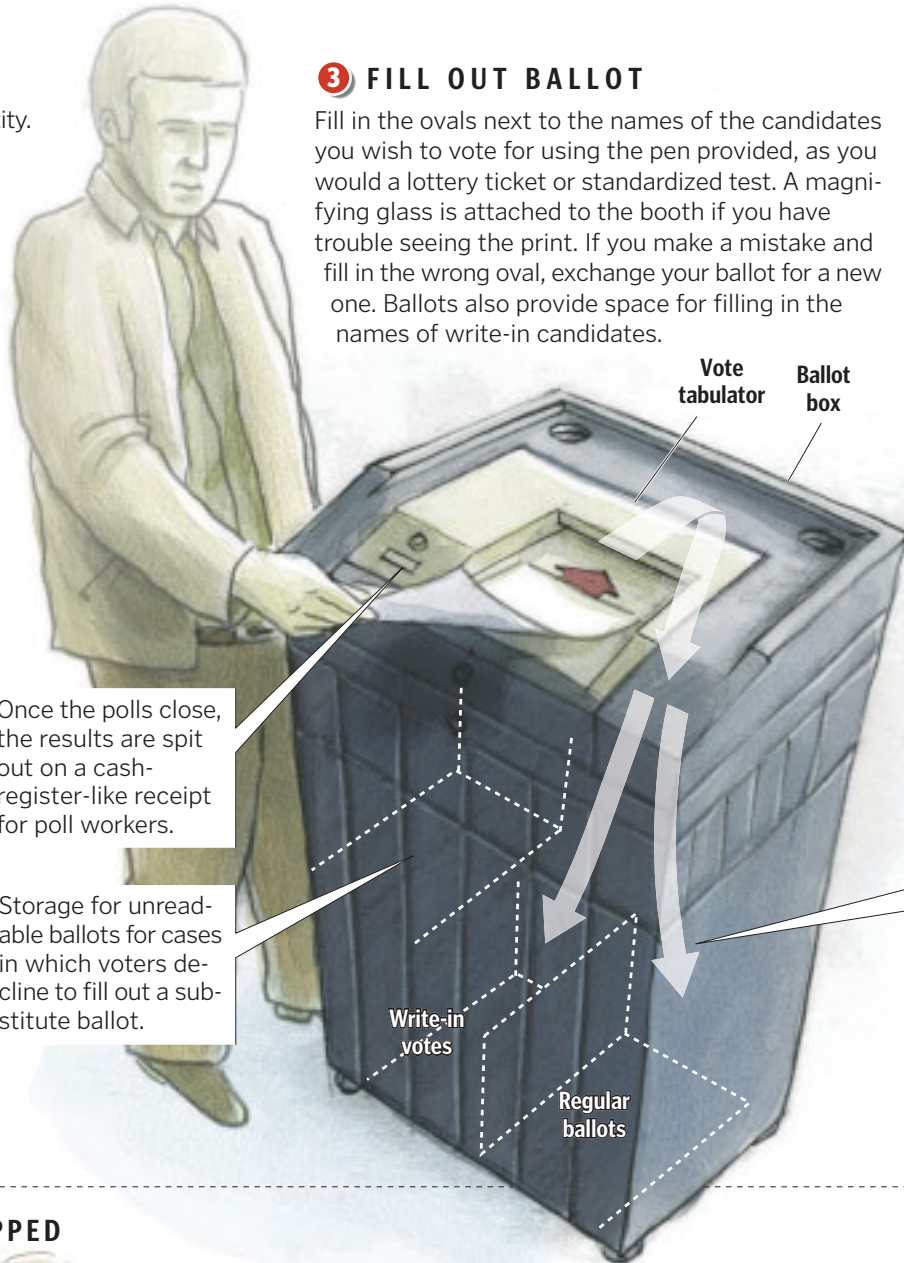

MACHINES FOR THE HANDICAPPED

After you sign in, a poll worker will set up the phone for your vote.

For the visually impaired:

Use the handset to listen to the voice prompts.

For the hearing-impaired: A set of headphones is available with adjustable volume.



Vote by touching the telephone keypad.

Hit ## to cast your ballot. A nearby fax machine will print your ballot with a blank cover page on top to protect your privacy. Election workers will tally the results by hand later.

The process should take about 10 to 15 minutes, depending on the length of the ballot.

THE PRIMARIES

On Sept. 11, 23 towns are scheduled to hold primaries:

Bridgeport	Lisbon
Bristol	Middlebury
Colchester	New Britain
Cornwall	New Haven
Cromwell	Oxford
Derby	Plainville
East Hartford	Preston
Griswold	Stratford
Hamden	West Haven
Hampton	Woodbury
Hartford	Woodstock
Lebanon	

WHERE TO VOTE

If you aren't sure where to vote, go to the website vote411.org and enter your ZIP code.

WHEN TO VOTE

Poll hours are from 6 a.m. to 8 p.m.

NOT REGISTERED?

You have until Sept. 6 to register by mail for the Sept. 11 primary, or by noon Sept. 10 in person, if a primary is taking place in your town. You have until Oct. 23 to register by mail for the Nov. 6 general election, or in person by Oct. 30.

POCKET GUIDE

The Secretary of the State is offering a pocket guide with instructions in English and in Spanish. Call 1-800-540-3764 or go to www.sots.ct.gov



SAMPLE BALLOT

The optical-scan ballots are different for each town, but all will follow the same format as this ballot for Hartford's Sept. 11 primary.

State of Connecticut Official Ballot		Hartford, Connecticut		District 14	Democratic Primary	Date of Primary September 11, 2007	
		PRIMARY VOTING INSTRUCTIONS ONLY I. The name or names of party-endorsed candidate appear list in each vertical column and the name of each party-endorsed candidate is marked with an asterisk. If there is no party endorsement, the designation "no party endorsement" appears under the office or position designation. II. There is no write-in voting at primaries.				1. El nombre o los nombres de los candidatos que han sido endosados por el partido aparecen primero en cada columna vertical y el nombre del candidato endosado por el partido estará señalado con un asterisco. Si el partido no ha endosado a nadie, la frase "no hay endosco" aparecerá bajo el título del cargo o puesto. 2. En las primarias no se permiten votos por escrito.	
		Be sure to read instructions on reverse side of this ballot. Asegúrese leer las instrucciones en el otro lado antes de marcar esta papeleta.					
OFFICE CARGO	1	2	3	4	5	6	7
	Mayor (Alcalde)	Councilmen (Representantes) Vote for Any Six Vote por Algunos Seis					
	<input type="radio"/> 1A Eddie A. Perez*	<input type="radio"/> 2A James M. Boucher*	<input type="radio"/> 3A Kenneth H. Kennedy, Jr.*	<input type="radio"/> 4A Matthew D. Ritter*	<input type="radio"/> 5A Pedro E. Segarra*	<input type="radio"/> 6A Calixto Torres*	<input type="radio"/> 7A R.J. Wisch*
	<input type="radio"/> 1B Frank D. Barrows	<input type="radio"/> 2B Them Page					
	<input type="radio"/> 1C Art J. Feltman						
	<input type="radio"/> 1D I. Charles Mathews						

2007 AUG 27 PM 2:21
LESLIE ALTMAN & ASSOCIATES
DESIGN
SECRETARY OF THE STATE